

PLAT OF SURVEY

- OF -

J.K. SURVEYING INC.
N3705 WILLOWBEND LANE
LAKE GENEVA, WI, 53147
262-248-3697

UNIT 70 LAUDERDALE LAKES ESTATES, A CONDOMINIUM, ADDENDUM # 1
LOCATED IN PART OF THE SOUTHEAST 1/4 AND SOUTHWEST 1/4 OF THE
NORTHEAST 1/4 AND PART OF THE NORTHWEST 1/4 OF THE SOUTHEAST 1/4
OF SECTION 1, TOWN 3 NORTH, RANGE 16 EAST, TOWN OF SUGER CREEK,
WALWORTH COUNTY, WISCONSIN.

PREPARED FOR : SHOREWEST REALTORS
C/O CATHY GRENNING
830 E GENEVA ST.
DELAVER WI. 53115

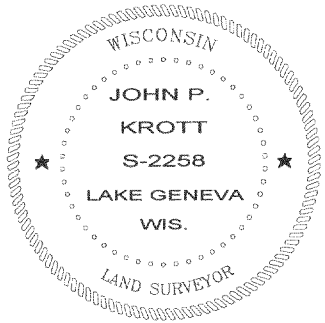

John P. Krott

JOHN KROTT S - 2258
Wisconsin Registered Land Surveyor
(original if signed in red)

DATED THIS THE 1st DAY OF JUNE 2005.

COMPARE LEGAL DESCRIPTION ABOVE AND DRAWING WITH DEED. FOR BUILDING RESTRICTIONS AND
EASEMENTS NOT SHOWN, REFER TO DEED, ABSTRACT SOURCES AND LOCAL MUNICIPAL CODES. NOTIFY
THE SURVEYOR IMMEDIATELY OF ANY DISCREPANCY.

"I hereby certify that I have surveyed the above described property and that
the above map, to the best of my knowledge and belief, is a true representation
thereof and shows the size and location of all visible structures, apparent
easements and encroachments if any."
This survey is made for the present owners of the property, and those who
purchase, mortgage, or guarantee the title thereto, within one year from
the date hereof.

C.L. S.T.H. "67" & U.S. "12"
(93' WIDE ROAD)

N 00°35'02" W 538.81'
(N 00°35'02" W 538.79')

60' WIDE LANDSCAPE EASEMENT

60.00'

74.9'

60.00'

⊙ ⊙
VENTS

⊕
CONCRETE LID
⊙
CLEANOUT

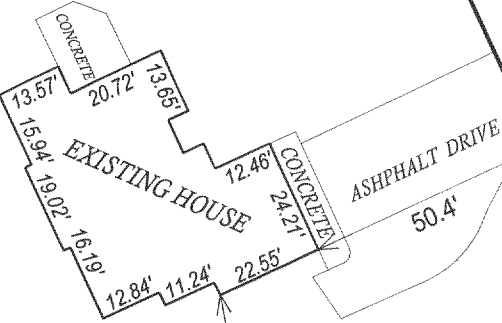

WELL
⊙ 65.0'

TELEPHONE PEDISTAL
⊙ 26.73'

S 78°48'28" W 225.69'
(S 78°48'38" W 225.61')

() = recorded as

□ = found iron bar

○ = found iron pipe

⊙ = 2" iron pipe

■ = set iron bar

SCALE 1" = 40'

JOB # 05-262

TAX ID # GLLE100018

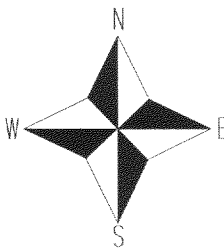

316-1765